

Monofocal Auto-Iris Lens

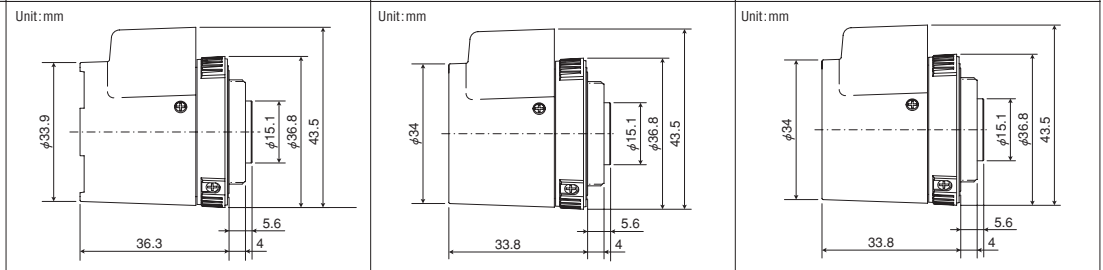

Model	TS212E (C70210)	TS412E (C70406)	TS812E (C70804)
Format Size	1/3	1/3	1/3
Focal Length	2.8mm	4.0mm	8.0mm
Max. Aperture Ratio	1:1.2	1:1.2	1:1.2
Iris Range	1.2~200	1.2~200	1.2~200
Mount	CS	CS	CS
Horizontal Angle of View	1/4 format	71.54°	49.18°
	1/3 format	94.28°	63.89°
	1/2 format	—	—
	2/3 format	—	—
Min. Object Distance	0.3m	0.2m	0.2m
Back Focal Length	7.67mm	8.01mm	7.73mm
Filter Size	—	—	—
Dimensions	36.8×43.5×36.3mm	36.8×43.5×33.8mm	36.8×43.5×33.8mm
Weight	54g	49g	44g
Remarks	DC Iris	DC Iris	DC Iris



Monofocal Auto-Iris Lens



Model	HS316E (C60309)	HS614E (C60630)	HS1214E (C61227)
Format Size	1/2	1/2	1/2
Focal Length	3.7mm	6.0mm	12.0mm
Max. Aperture Ratio	1:1.6	1:1.4	1:1.4
Iris Range	1.6~300	1.4~300	1.4~300
Mount	CS	CS	CS
Horizontal Angle of View	1/4 format	53.50°	33.83°
	1/3 format	70.96°	44.52°
	1/2 format	93.58°	57.79°
	2/3 format	—	—
Min. Object Distance	0.2m	0.2m	0.5m
Back Focal Length	8.99mm	10.49mm	10.38mm
Filter Size	34mm P=0.5mm	34mm P=0.5mm	34mm P=0.5mm
Dimensions	42.8×47.1×36.5mm	42.8×47.1×36.5mm	42.8×47.1×36.5mm
Weight	57g	60g	46g
Remarks	DC Iris	DC Iris	DC Iris

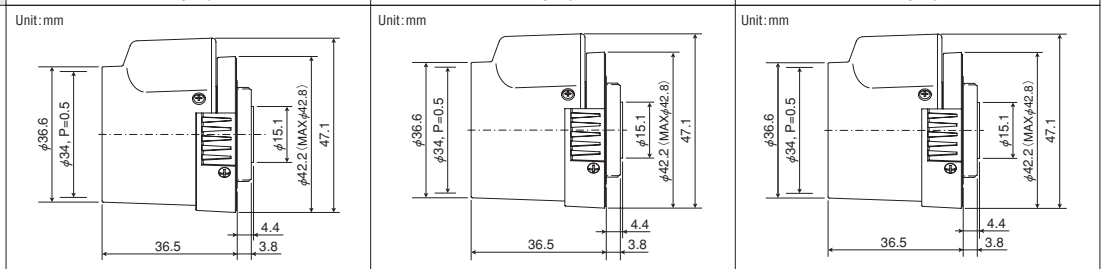

Monofocal Auto-Iris Lens



Model	H416E (C60405)		H612E (C60625)		H1212E (C61220)	
Format Size	1/2		1/2		1/2	
Focal Length	4.2mm		6.0mm		12.0mm	
Max. Aperture Ratio	1:1.6		1:1.2		1:1.2	
Iris Range	1.6~360		1.2~360		1.2~360	
Mount	C		C		C	
Horizontal Angle of View	1/4 format	47.87°	32.97°	16.94°	16.94°	16.94°
	1/3 format	64.27°	43.55°	22.60°	22.60°	22.60°
	1/2 format	86.77°	56.93°	30.19°	30.19°	30.19°
	2/3 format	—	—	—	—	—
Min. Object Distance	0.2m		0.2m		0.3m	
Back Focal Length	10.40mm		14.30mm		13.90mm	
Filter Size	—		43mm P=0.75mm		43mm P=0.75mm	
Dimensions	46.5×50.5×45mm		46.5×50.5×51.1mm		46.5×50.5×51.1mm	
Weight	135g		140g		140g	
Remarks	Video Iris Manual Override: H416ER (C60404)		Video Iris Manual Override: H612ER (C60624)		Video Iris Manual Override: H1212ER (C61219)	

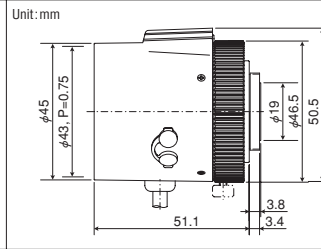
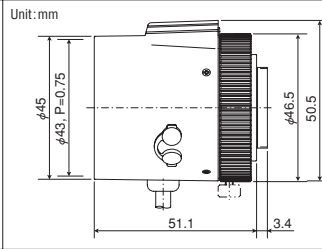
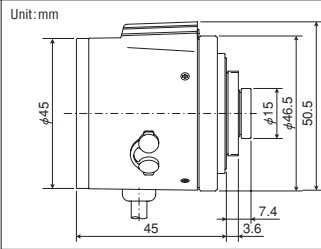

Monofocal Auto-Iris Lens



Model	C814E (C30821)		B1214E (C21223)		C1614E (C31632)	
Format Size	2/3		1		2/3	
Focal Length	8.0mm		12.5mm		16.0mm	
Max. Aperture Ratio	1:1.4		1:1.4		1:1.4	
Iris Range	1.4~360		1.4~360		1.4~360	
Mount	C		C		C	
Horizontal Angle of View	1/4 format	25.10°	16.22°	12.72°	12.72°	12.72°
	1/3 format	33.22°	21.55°	16.92°	16.92°	16.92°
	1/2 format	43.67°	28.54°	22.50°	22.50°	22.50°
	2/3 format	58.25°	38.69°	30.76°	30.76°	30.76°
Min. Object Distance	0.2m		0.3m		0.5m	
Back Focal Length	14.50mm		14.40mm		13.20mm	
Filter Size	43mm P=0.75mm		43mm P=0.75mm		43mm P=0.75mm	
Dimensions	46.5×50.5×51.1mm		46.5×50.5×47.5mm		46.5×50.5×46.7mm	
Weight	140g		140g		110g	
Remarks	Video Iris Manual Override: C814ER (C30820)		Video Iris Manual Override: B1214ER (C21221)		Video Iris Manual Override: C1614ER (C31631)	

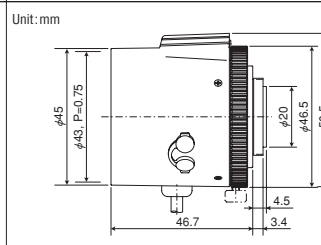
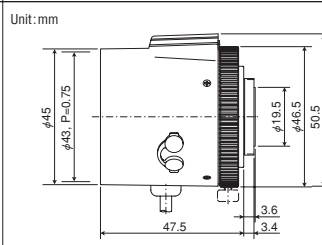
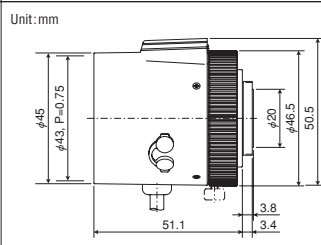

Monofocal Auto-Iris Lens

Monofocal Auto-Iris Lens



Model	B2514E (C22527)		B5018E (C25018)		B7518AE (C27515)	
Format Size	1		1		1	
Focal Length	25.0mm		50.0mm		75.0mm	
Max. Aperture Ratio	1:1.4		1:1.8		1:1.8	
Iris Range	1.4~360		1.8~360		1.8~360	
Mount	C		C		C	
Horizontal Angle of View	1/4 format	8.23°	4.13°	2.74°		
	1/3 format	10.97°	5.50°	3.65°		
	1/2 format	14.62°	7.32°	4.87°		
	2/3 format	20.09°	10.04°	6.69°		
Min. Object Distance	0.9m		1.0m		2.5m	
Back Focal Length	14.98mm		31.70mm		29.08mm	
Filter Size	43mm P=0.75mm		49mm P=0.75mm		49mm P=0.75mm	
Dimensions	46.5×50.5×51.8mm		62×51mm		62×70.5mm	
Weight	140g		230g		300g	
Remarks	Video Iris Manual Override: B2514ER (C22526)		Video Iris Manual Override: B5018ER (C25017)		Video Iris	

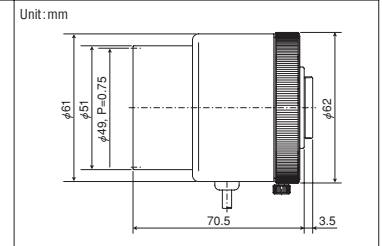
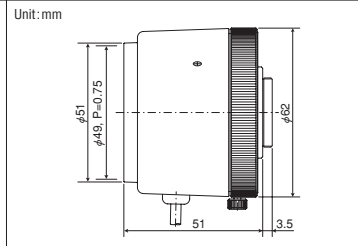
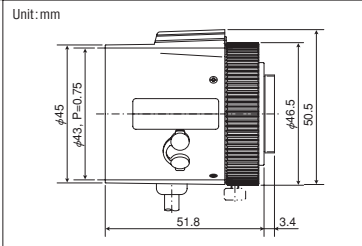

Pinhole Lens



Model	TS420PE (C70403)		H620PE (C60626)	
Format Size	1/3		1/2	
Focal Length	4.0mm		6.2mm	
Max. Aperture Ratio	1:2.0		1:2.0	
Iris Range	2.0-64		2.0~300	
Mount	CS		C	
Horizontal Angle of View	1/4 format	51.24°	32.44°	
	1/3 format	68.47°	42.82°	
	1/2 format	—	56.12°	
	2/3 format	—	—	
Min. Object Distance	0.3m		0.3m	
Back Focal Length	8.55mm		14.23mm	
Filter Size	—		—	
Dimensions	36.5×42.3×65.9		39×45.5×83.2mm	
Weight	79g		100g	
Remarks	DC Iris		Video & DC Iris	

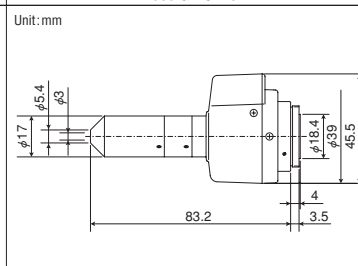
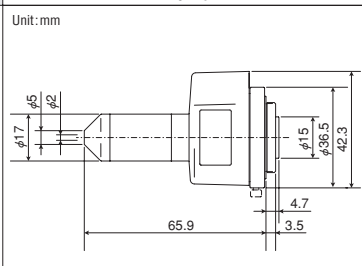

MODEL	Focal length (mm)	Iris range	Mount	Horizontal Angle of View (°)				Filter size	Dimensions (D×L) (W×H×L) mm	Weight (g)	Remarks	Page
				1/4 format	1/3 format	1/2 format	2/3 format					

● Monofocal Manual Iris Lens

1/2 format												
H416 (C60402)	4.2	1.6-C	C	47.87	64.27	86.77	—	—	42×43.5	120	Lock Screw	6
H612A (C60607)	6.0	1.2-C	C	32.97	43.55	56.93	—	40.5 P=0.5	42×46	125	Lock Screw	6
H1212B (C61215)	12.0	1.2-22	C	16.93	22.60	30.18	—	27.0 P=0.5	30×35.5	67	Lock Screw	6

2/3, 1 format												
C418DX (C30405)	4.8	1.8-C	C	41.68	55.11	72.37	96.36	—	40.5×35.5	105	Lock Screw	6
C815B (C30811)	8.5	1.5-C	C	24.02	31.87	42.09	56.49	40.5 P=0.5	42×40	120	Lock Screw	6
B1214D-2 (C21211)	12.5	1.4-C	C	16.21	21.53	28.51	38.65	40.5 P=0.5	42×50	135	Lock Screw	6
B1218A (C21228)	12.5	1.8-C	C	16.53	21.97	29.12	39.56	40.5 P=0.5	42×40	95	Lock Screw	7
C1614A (C31630)	16.0	1.4-22	C	12.70	16.91	22.48	30.72	27.0 P=0.5	30×33	58	Lock Screw	7
B2514D (C22525)	25.0	1.4-22	C	8.23	10.97	14.62	20.10	27.0 P=0.5	30×37.3	76	Lock Screw	7
B2518 (C22516)	25.0	1.8-C	C	8.23	10.95	14.55	19.87	40.5 P=0.5	42×40	87	Lock Screw	7
B5014A (C25011)	50.0	1.4-C	C	4.13	5.50	7.32	10.04	46.0 P=0.75	48×48	180	Lock Screw	7
B7514C (C27509)	75.0	1.4-C	C	2.75	3.67	4.90	6.75	58.0 P=0.75	62×79	450	Lock Screw	7

● Machine Vision Mega-Pixel Lens

1/2 format												
H1214-M (C61232)	12.0	1.4-16	C	16.49	21.88	28.91	—	27.0 P=0.5	29.5×28.5	55	Lock Screw	8

2/3 format												
C1614-M (C31634)	16.0	1.4-16	C	12.86	17.11	22.72	30.97	27.0 P=0.5	29.5×33.2	63	Lock Screw	8
C2514-M (C32500)	25.0	1.4-16	C	8.24	10.97	14.60	20.00	27.0 P=0.5	29.5×32	55	Lock Screw	8
C3516-M (C33500)	35.0	1.6-16	C	6.07	8.09	10.76	14.76	27.0 P=0.5	29.5×35.4	64	Lock Screw	8
C5028-M (C35001)	50.0	2.8-22	C	4.12	5.50	7.32	10.05	27.0 P=0.5	29.5×34	55	Lock Screw	8
C7528-M (C37500)	75.0	2.8-32	C	2.83	3.77	5.03	6.90	30.5 P=0.5	34×59.6	125	Lock Screw	8

● Line-Scan Lens

YF3528 (C52915F)	35.0	2.8-22	F	64.4 (45mm Image Format)				62 P=0.75	72×56.8	440	Not for photographic cameras	9
YK3528 (C52915K)	35.0	2.8-22	K	64.4 (45mm Image Format)				62 P=0.75	72×57.8	440	Not for photographic cameras	(9)
YF5028 (C52893F)	50.0	2.8-22	F	47.6 (45mm Image Format)				62 P=0.75	72×56.8	440	Not for photographic cameras	9
YK5028 (C52893K)	50.0	2.8-22	K	47.6 (45mm Image Format)				62 P=0.75	72×57.8	440	Not for photographic cameras	(9)

● UV Lens (Ultraviolet Ray)

1/2 format												
H2520-UV (C62500)	25.0	2.0-16	C	8.24	10.98	14.62	—	27 P=0.5	29.5×46	78	200nm-1000nm Ray	9

1 format												
B2528-UV (C91699)	25.0	2.8-16	C	8.30	11.10	14.80	20.40	25.5 P=0.5	30×25.4	33	230nm-800nm Ray	9
B7838-UV (C91698)	78.0	3.8-16	C	2.70	3.50	4.70	6.50	49 P=0.75	62.5×109.3	446		9

● Monofocal Auto-Iris Lens

1/3 format												
TS212E (C70210)	2.8	1.2-200	CS	71.54	94.28	—	—	—	36.8×43.5×36.3	54	DC Iris	10
TS412E (C70406)	4.0	1.2-200	CS	49.18	63.89	—	—	—	36.8×43.5×33.8	49	DC Iris	10
TS812E (C70804)	8.0	1.2-200	CS	25.05	33.33	—	—	—	36.8×43.5×33.8	44	DC Iris	10

1/2 format												
HS316E (C60309)	3.7	1.6-300	CS	53.50	70.96	93.58	—	34 P=0.5	42.8×47.1×36.5	57	DC Iris	10
HS614E (C60630)	6.0	1.4-300	CS	33.83	44.52	57.79	—	34 P=0.5	42.8×47.1×36.5	60	DC Iris	10
HS1214E (C61227)	12.0	1.4-300	CS	16.52	22.03	29.38	—	34 P=0.5	42.8×47.1×36.5	46	DC Iris	10
H416E (C60405)	4.2	1.6-360	C	47.87	64.27	86.77	—	—	46.5×50.5×45	135	Video Iris	11
H416ER (C60404)	4.2	1.6-360	C	47.90	64.30	86.78	—	—	46.5×50.5×45	135	Video Iris	(11)
H612E (C60625)	6.0	1.2-360	C	32.97	43.55	56.93	—	43 P=0.75	46.5×50.5×51.1	140	Video Iris	11
H612ER (C60624)	6.0	1.2-360	C	32.96	43.54	56.91	—	43 P=0.75	46.5×50.5×51.1	140	Video Iris	(11)
H1212E (C61220)	12.0	1.2-360	C	16.94	22.60	30.19	—	43 P=0.75	46.5×50.5×51.1	140	Video Iris	11
H1212ER (C61219)	12.0	1.2-360	C	16.94	22.60	30.19	—	43 P=0.75	46.5×50.5×51.1	140	Video Iris	(11)

2/3, 1 format												
C814E (C30821)	8.0	1.4-360	C	25.10	33.22	43.67	58.25	43 P=0.75	46.5×50.5×51.1	140	Video Iris	11
C814ER (C30820)	8.0	1.4-360	C	25.10	33.22	43.67	58.25	43 P=0.75	46.5×50.5×51.1	140	Video Iris	(11)
B1214E (C21223)	12.5	1.4-360	C	16.22	21.55	28.54	38.69	43 P=0.75	46.5×50.5×47.5	140	Video Iris	11
B1214ER (C21221)	12.5	1.4-360	C	16.22	21.55	28.54	38.69	43 P=0.75	46.5×50.5×47.5	140	Video Iris	(11)
C1614E (C31632)	16.0	1.4-360	C	12.72	16.92	22.50	30.76	43 P=0.75	46.5×50.5×46.7	110	Video Iris	11
C1614ER (C31631)	16.0	1.4-360	C	12.70	16.92	22.50	30.76	43 P=0.75	46.5×50.5×46.7	110	Video Iris	(11)
B2514E (C22527)	25.0	1.4-360	C	8.23	10.97	14.62	20.09	43 P=0.75	46.5×50.5×51.8	140	Video Iris	12
B2514ER (C22526)	25.0	1.4-360	C	8.23	10.97	14.62	20.09	43 P=0.75	46.5×50.5×51.8	140	Video Iris	(12)
B5018E (C25018)	50.0	1.8-360	C	4.13	5.50	7.32	10.04	49 P=0.75	62×51	230	Video Iris	12
B5018ER (C25017)	50.0	1.8-360	C	4.13	5.50	7.32	10.04	49 P=0.75	62×51	230	Video Iris	(12)
B7518AE (C27515)	75.0	1.8-360	C	2.74	3.65	4.87	6.69	49 P=0.75	62×70.5	300	Video Iris	12

MODEL	Focal length (mm)	Iris range	Mount	Horizontal Angle of View (°)				Filter size	Dimensions (D×L)(W×H×L) mm	Weight (g)	Remarks	Page
				1/4 format	1/3 format	1/2 format	2/3 format					

● Pinhole Lens

1/3 format

TS420PE (C70403)	4.0	2.0-64	CS	51.24	68.47	—	—	—	36.5×42.3×65.9	79	DC Iris	12
------------------	-----	--------	----	-------	-------	---	---	---	----------------	----	---------	----

1/2 format

H620PE (C60626)	6.2	2.0-300	C	32.44	42.82	56.12	—	—	39×45.5×83.2	100	Video & DC Iris	12
-----------------	-----	---------	---	-------	-------	-------	---	---	--------------	-----	-----------------	----

● Vari-Focal Lens

1/3 format

TS2V114E (C70100)	1.6-3.4	1.4-64	CS	180-64.89	180-89.55	—	—	—	38.3×44.7×56.7	140	Fish-Eye, DC Iris	13
TS2V214AED (C70220)	2.8-6.0	1.4-300	CS	72.26-35.35	96.70-47.04	—	—	—	40.4×45.7×43.2	59	Video & DC Iris, Day & Night	13
TS2V314CED (C70319)	3.5-8.0	1.4-300	CS	60.52-26.54	82.41-35.42	—	—	—	38.3×44.7×44.2	52	DC Iris	13
TS3V310 (C70316)	3.0-8.0	1.0-C	CS	68.98-26.44	93.22-35.26	—	—	—	36.2×44.4	47	Manual Iris, Day&Night	13
TS3V310ED (C70315)	3.0-8.0	1.0-360	CS	68.98-26.44	93.22-35.26	—	—	—	38.3×44.7×44.4	60	Video & DC Iris, Day & Night	13
TS4V214ED (C70223)	2.8-12	1.4-360	CS	71.82-18.05	93.29-23.50	—	—	—	43.0×51.5×63.5	83	DC Iris	14
TS10V518AED (C70508)	5.0-50	1.8-360	CS	37.80-4.14	50.00-5.52	—	—	—	44.5×50.8×61.5	140	DC Iris	14

1/2 format

HS2V616ED (C60635)	6.0-12	1.6-300	CS	34.98-17.23	47.38-23.02	65.29-30.82	—	30.5 P=0.5	40.4×45.7×43.5	57	Video & DC Iris, Day & Night	14
--------------------	--------	---------	----	-------------	-------------	-------------	---	------------	----------------	----	------------------------------	----

● Manual Zoom Lens

1/3 format

TS6ZE (C70605)	6.3-38	1.2-512	CS	31.26-5.59	41.12-7.43	—	—	49 P=0.75	57.5×77.8	320	Video & DC Iris	15
----------------	--------	---------	----	------------	------------	---	---	-----------	-----------	-----	-----------------	----

1/2 format

H6ZB10 (C60812)	8.0-48	1.0-22	C	24.92-4.42	32.99-5.86	43.26-7.73	—	55 P=0.75	57×95	430	Manual Iris	15
H6ZBE (C60811)	8.0-48	1.0-720	C	24.92-4.42	32.98-5.86	43.24-7.73	—	55 P=0.75	69×64×95	465	Video & DC Iris	15

2/3 format

C6Z1218 (C31204)	12.5-75	1.8-22	C	16.07-2.75	21.38-3.66	28.41-4.87	38.76-6.67	49 P=0.75	51×90	320	Manual Iris	15
C6ZE (C31219)	12.5-75	1.8-720	C	16.05-2.75	21.36-3.66	28.38-4.87	38.72-6.67	49 P=0.75	68×90	385	Video Iris	15

● Motorized Zoom Lens

1/3 format

TS6ZME (C70600)	6.3-38	1.2-360	CS	31.26-5.59	41.12-7.43	—	—	49 P=0.75	58×63.5×78	410	Video & DC Iris	16
TS10ZME (C70500)	5.8-58	1.2-360	CS	33.77-3.62	44.07-4.78	—	—	49 P=0.75	64.6×70.3×85	380	Video & DC Iris	16
TS10ZME-P (C70501)	5.8-58	1.2-360	CS	33.77-3.62	44.07-4.78	—	—	49 P=0.75	64.6×70.3×85	430	Video & DC Iris	16
TS15ZAME (C70624)	6.0-90	1.2-430	CS	32.96-2.33	43.48-3.08	—	—	62 P=0.75	78×88.5×119	760	Video & DC Iris	17
TS15ZAME-P (C70627)	6.0-90	1.2-430	CS	32.96-2.33	43.48-3.08	—	—	62 P=0.75	78×88.5×119	770	Video & DC Iris	17
TS20ZAME (C70904)	9.0-180	1.2-510	CS	22.61-1.15	30.28-1.53	—	—	95 P=1.0	116×135×223.5	2540	Video & DC Iris	17
TS20ZAME-P (C70906)	9.0-180	1.2-510	CS	22.61-1.15	30.28-1.53	—	—	95 P=1.0	116×135×223.5	2540	Video & DC Iris	17

1/2 format

HS6ZME (C60806)	8.0-48	1.4-360	CS	24.81-4.39	32.78-5.82	42.88-7.69	—	49 P=0.75	58×63.5×78	400	Video & DC Iris	18
H6ZBME (C60809)	8.0-48	1.0-720	C	24.92-4.42	32.98-5.86	43.24-7.73	—	55 P=0.75	64×74.5×97	530	Video & DC Iris	18
H6ZBME-P (C60810)	8.0-48	1.0-720	C	24.92-4.42	32.98-5.86	43.24-7.73	—	55 P=0.75	64×74.5×97	540	Video & DC Iris	18
HS10ZME (C60700)	7.5-75	1.4-360	CS	26.15-2.83	34.52-3.75	45.05-4.95	—	58 P=0.75	67×75×112	580	Video & DC Iris	19
H10ZME (C60701)	7.5-75	1.2-512	C	26.45-2.84	34.94-3.77	45.63-4.99	—	62 P=0.75	70×80.5×121.5	715	Video & DC Iris	19
H10ZME-P (C60702)	7.5-75	1.2-512	C	26.45-2.84	34.94-3.77	45.63-4.99	—	62 P=0.75	70×80.5×121.5	740	Video & DC Iris	19
H15ZAME (C60826)	8.0-120	1.6-1000	C	24.76-1.76	32.85-2.34	43.37-3.09	—	62 P=0.75	78×88.5×134	800	Video & DC Iris	20
H15ZAME-P (C60829)	8.0-120	1.6-1000	C	24.76-1.76	32.85-2.34	43.37-3.09	—	62 P=0.75	78×88.5×134	810	Video & DC Iris	20
H20ZAME (C61237)	12-240	1.6-720	C	17.17-0.88	22.95-1.17	30.78-1.56	—	95 P=1.0	116×135×223.5	2590	Video & DC Iris	20
H20ZAME-P (C61239)	12-240	1.6-720	C	17.17-0.88	22.95-1.17	30.78-1.56	—	95 P=1.0	116×135×223.5	2620	Video & DC Iris	20
H55ZME-F (C61233)	12-1320	4.0-360	C	17.17-0.31	23.18-0.21	31.65-0.28	—	105 P=1.0	155×138×355	5400	Video Iris	21
H18ZME-F (C60839)	8.0-144	1.6-720	C	25.67-1.43	34.10-1.91	45.10-2.55	—	—	139.8×151.9×210	3840	Video Iris, Day & Night	21

2/3 format

C6Z1218M3 (C31211)	12.5-75	1.8-C	C	16.08-2.75	21.40-3.66	28.44-4.87	38.82-6.67	49 P=0.75	101.5×92.2×94.5	820	Motorized Iris	22
C6ZAME (C31220)	12.5-75	1.8-720	C	16.07-2.75	21.36-3.66	28.38-4.87	38.72-6.67	49 P=0.75	101.5×92.2×94.5	620	Video Iris	22

● Board Camera Lens

1/4 format

QD222E (C40214)	2.3	2.2-128	φ14	88.20	—	—	—	—	19×31×20.9	8	DC Iris	23
QD320E (C40302)	3.0	2.0-200	φ14	69.14	—	—	—	—	19×31×18.2	8	DC Iris	23
QD420E (C40402)	4.0	2.0-200	φ14	51.86	—	—	—	—	19×31×17.5	8	DC Iris	23
QD2V2214AE (C40209)	2.2-4.5	1.4-200	φ14	93.36-45.75	—	—	—	—	29.6×37.3×32	27	DC Iris	23
QD2V2814AE (C40208)	2.8-5.8	1.4-200	φ14	74.62-35.87	—	—	—	—	29.6×37.3×32.1	26	DC Iris	23
QD2V2214BE-DN (C40216)	2.2-4.5	1.4-200	φ14	92.84-45.88	—	—	—	—	29.6×50.2×31.9	34	DC Iris, Day & Night	24
QD2V2814BE-DN (C40217)	2.8-5.8	1.4-200	φ14	74.67-35.86	—	—	—	—	29.6×50.2×31.9	33	DC Iris, Day & Night	24
QD3ZMED (C40219)	2.8-7.3	1.9-200	Special	73.42-28.74	—	—	—	—	35.1×29.7×26.8	18	DC Iris	24

1/3 format

TD3V314E-DN (C70318)	3.0-8.0	1.4-300	φ14	68.67-26.48	92.55-35.28	—	—	—	29.6×41.2×33.1	29	DC Iris, Day & Night	24
----------------------	---------	---------	-----	-------------	-------------	---	---	---	----------------	----	----------------------	----